

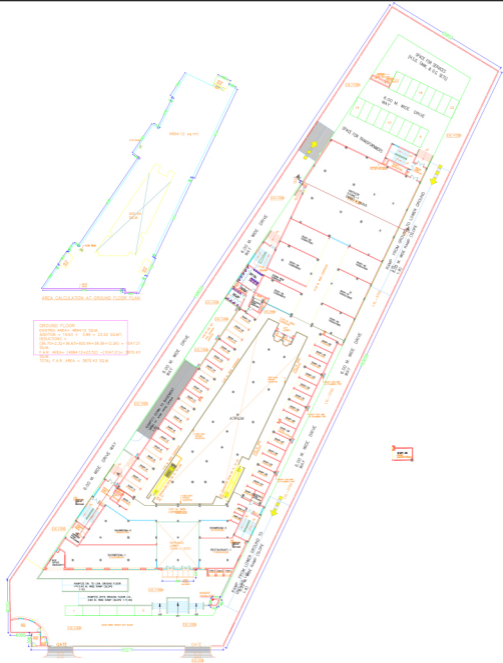



GROUND FLOOR  
 EXISTING AREA = 4094.12 SQ.M  
 RECTANGLE = 16.42 x 249 = 4087.58 SQ.M  
 RECTANGLE = 16.72 x 249 = 4163.28 SQ.M  
 AREA OF TRIANGLE = 1/2 x 16.72 x 249 = 2081.64 SQ.M  
 TOTAL F.A.A. AREA = 3076.43 SQ.M



EXISTING BUILDING PLAN OF SHOPPING MALL/MULTIPLEX BUILDING AT RHODPA ROAD, MUZZAFFARNAGAR AND SITUATED AT PANIPAT-KHATIMA ROAD, FROM PANPAT

OWNER - M/S. A.S.I. DEVELOPERS

OWNER'S SIGN

ARCHITECT'S SIGN

DRAWING TITLE

GROUND FLOOR PLAN  
 SCALE: 1:200



ARCHITECTS:

MUKESH & ASSOCIATES  
 B-02, 1st Floor, SHOPPING COMPLEX, GATEWAY, PART - I, NO. 141-142, 143

22/10/20

19/10/20

mukesh@shilpa.com

AREA CALCULATION AT FIRST FLOOR PLAN

FIRST FLOOR  
 EXISTING AREA= 4894.12 SQ.M.  
 DEDUCTIONS =  
 $(36.70+6.10+2.32+36.83+1.53+5.08+108.77+820.84+2.16+1.68+2.73+4.16+4.16+36.36+12.26)$   
 = 1254.56 SQ.M.  
 F.A.R. AREA= (4894.12-1254.56)= 3639.56 SQ.M.  
 TOTAL F.A.R. AREA = 3639.56 SQ.M.

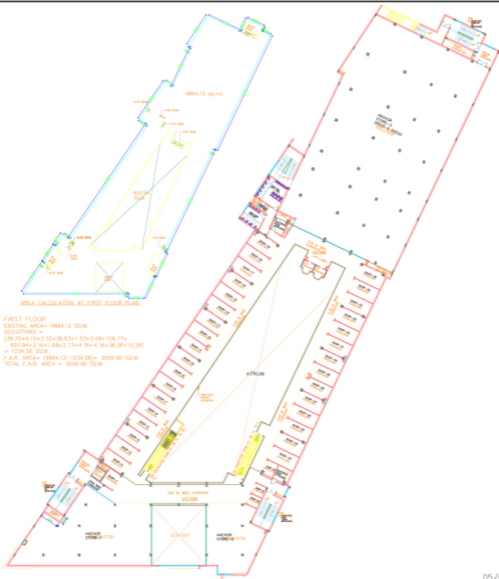

EXISTING BUILDING PLAN OF SHOPPING MALL/MULTIPLEX  
 BUILDING AT BHOPA ROAD, MUZZAFFARNAGAR AND  
 SITUATED AT PANIPAT-KHATMA ROAD, FROM PANIPAT.  
 OWNER-M/S A.S.J. DEVELOPERS.

OWNER'S SIGN

ARCHITECT'S SIGN

DRAWING TITLE

FIRST FLOOR PLAN  
 SCALE: 1=200



ARCHITECTS

MUKESH & ASSOCIATES  
 8-33, 3rd Floor, SHOPPING  
 CENTER  
 WAZIRpur, PART-1, NEAR  
 110008

23/01/20  
 [E-mail: [msh@mkac.in](mailto:msh@mkac.in)]  
 9846779600



**SECOND FLOOR**  
 EXISTING AREA =  $1080.53 + 2000.14 + 411.27 + 196.08 = 3688.02$  SQ.MT.  
 REDUCTIONS =  
 $9.70 + 10 + 9.08 + 2.32 + 1.53 + 36.63 + 4.18 + 4.18 + 2.18 + 36.38 + 12.26 = 110.49$  SQ.M.  
 F.A.R. AREA =  $3278.47 = 148.44 \times 2508.99$  SQ.M.  
 TOTAL F.A.R. AREA =  $3008.94$  SQ.M.



EXISTING BUILDING PLAN OF SHOPPING MALL/MULTIPLEX  
 BUILDING AT BHOPA ROAD, MUZAFFARNAGAR AND  
 SITUATED AT PANIPAT-KHATMA ROAD, FROM PANIPAT.  
 OWNER-M/S. A.S.J. DEVELOPERS.

SECOND FLOOR PLAN  
 SCALE: 1:200  
 DRAWING TITLE



ARCHITECTS:  
 MUKESH & ASSOCIATES  
 B-03, 1st Floor, SHOPPING  
 CENTRE,  
 GATEWAY MARKET - I, NIZAMUDDIN  
 CROSSING  
 2247290  
 E-mail: mukesh@mkash.com